

Accuren Torrent Zip 64bit Windows Build Full Version Registration

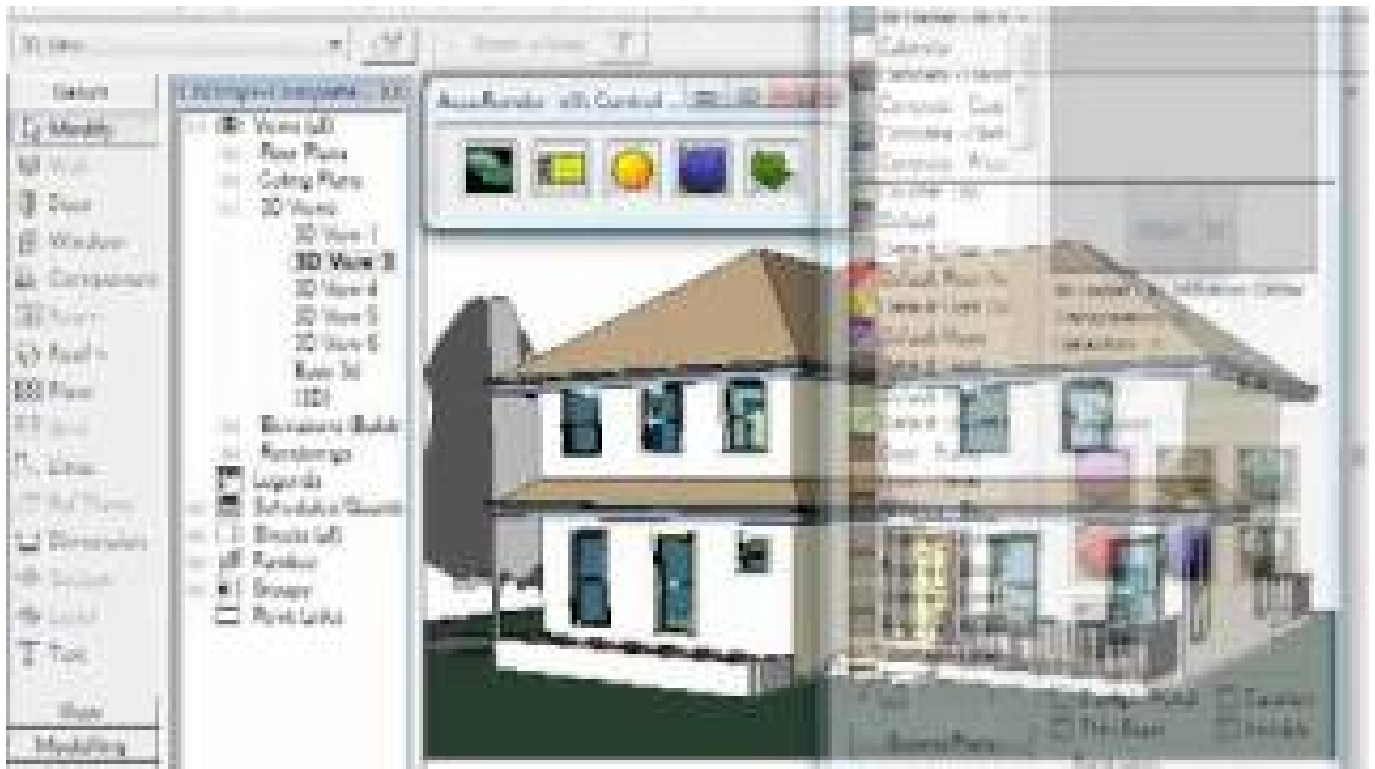

DOWNLOAD: <https://byltly.com/2into2>

Download



autodesk corel dwg excell graphic illustrator psp photoshop powerpoint quark studio etc...Left internal mammary artery grafting in the diabetic patient: is there an increased early mortality? The aim of this study was to compare outcomes in diabetic patients undergoing myocardial revascularization by left internal mammary artery (LIMA) grafting with those undergoing saphenous vein (SV) grafting. We reviewed the medical records of consecutive patients who underwent isolated myocardial revascularization by either LIMA or SV grafting between January 1994 and June 1998. Of 312 myocardial revascularizations performed in 297 patients (177 LIMA, 135 SV) 13 (5%) were on diabetic patients (7 LIMA, 6 SV). The mean age of the entire cohort was 58 years, 7 had diabetes, and only 6 were women. With LITA grafting, the overall early mortality rate was significantly higher in diabetics (2 of 13, 15%) compared with non-diabetics (3 of 284, 1%; $p = 0.02$). Among diabetic patients, 5 (71%) died and 2 (29%) survived. In non-diabetics, 1 (2%) died and 4 (8%) survived ($p = 0.01$). The overall early mortality rate was significantly higher for SV grafting compared with LIMA grafting (8 of 135, 6% compared with non-diabetics ($p = 0.02$), but this was not true for diabetic patients ($p = 0.09$). On univariate analysis, LITA grafting was associated with a higher overall mortality rate ($p = 0.04$) and LIMA grafting was associated with a lower mortality rate ($p = 0.05$). On multivariate analysis, diabetes was associated with an increased mortality rate ($p = 0.03$). LIMA grafting is an excellent strategy for myocardial revascularization in patients with diabetes, regardless of the heart disease. A DC-to-DC converter receives an input DC voltage from a DC power source and converts the input DC voltage to a different DC voltage. This DC-to-DC converter may be utilized, for example, to provide a direct current supply to one or more integrated circuits (ICs) on an IC card. FIG. 1 is a block diagram of a DC-to-DC converter 100 according to the prior art. The DC- 82157476af

[Colorschemer Studio 210 Keygen Music](#)

[Aimbot Cs 1.6.epub](#)

[Train Simulator: Miami - West Palm Beach Route Add-On download no password](#)